

NOTES

- 1 FOR STANDARD NOTES REFER TO DRAWING No. 29043/CD/000
- 2 THIS DRAWING SHALL BE READ IN CONJUNCTION WITH ALL RELEVANT ARCHITECTURAL, SERVICES AND M.E.A. DRAWINGS
- 3 ALL DIMENSIONS ARE IN MILLIMETRES UNLESS OTHERWISE NOTED. LEVELS ARE STRUCTURAL LEVELS IN METRES TO ORDNANCE DATUM. THIS DRAWING MUST NOT BE SCALED.

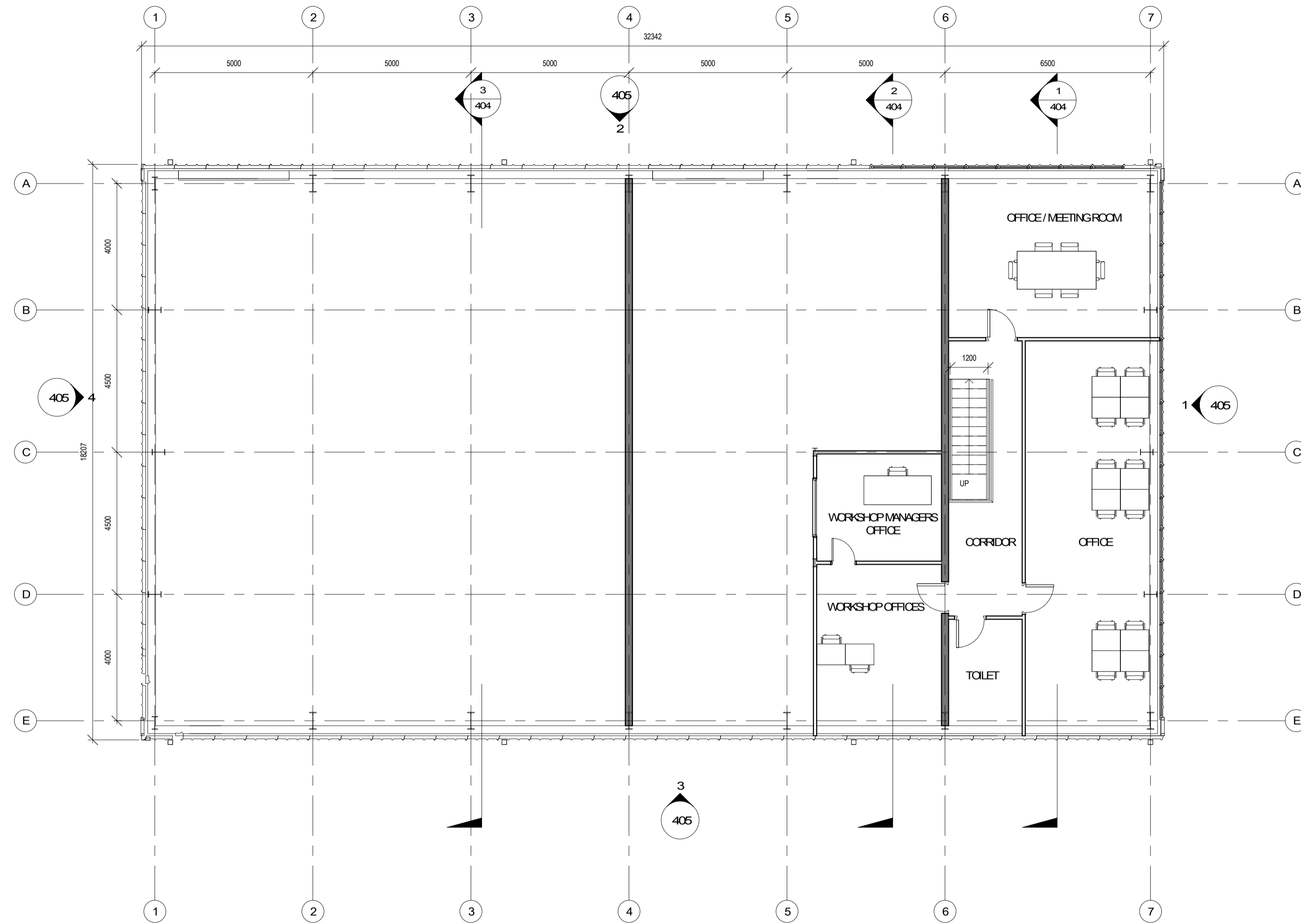
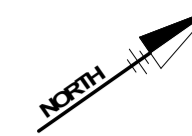

PROPOSED WAREHOUSE, WORKSHOP & OFFICE/ERT FIRST FLOOR GA
SCALE: 1:100 @A1

MATERIAL LEGEND

1.	ALL CLADDING AND ROOFING TO BE POWDER COATED KINGS PANKS 1000 RWECO SAFE KAKI GREEN RAL 6013.
2.	ALL VERTICAL AND HORIZONTAL FLASHING TO BE PRESSED METAL WITH FINISH TO MATCH CLADDING - KAKI GREEN RAL 6013.
3.	POLYCARBONATE TRANSLUCENT SHEETING.
4.	POWDER COATED METAL DOOR - COLOUR ANTHRACITE GREY RAL 7016.
5.	METAL POWDER COATED LUMBERS - COLOUR ANTHRACITE GREY RAL 7016.
6.	INSULATED METAL ROOF COVERING - KAKI GREEN RAL 6013.
7.	GUTTERS AND DOWNPIPES TO BE ANTHRACITE GREY RAL 7016.
8.	ALL EXPOSED STRUCTURAL STEEL TO BE GALVANISED.
9.	EXPOSED WALLING TO BE FINISHED WITH CAST-IN-PLACE CONCRETE / PLASTER BLOCK WORK.

C	ISSUED FOR PLANNING	AD	NK	14/05/20
B	ISSUED FOR COMMENT	RN	NK	22/11/19
A	ISSUED FOR INFORMATION	RN	NK	11/10/19

REV.	DESCRIPTION	BY.	APPR.	DATE
------	-------------	-----	-------	------

THIS DOCUMENT IS COPYRIGHT AND THE PROPERTY OF McElroy Associates. THIS DOCUMENT IS NOT TO BE REPRODUCED, MODIFIED OR RELAYED IN PART OR IN WHOLE TO ANY OTHER PERSON OR ORGANISATION WITHOUT THE PRIOR WRITTEN PERMISSION OF McElroy Associates.

McElroy Associates
ENGINEERS TO INDUSTRY
72 Haddington Road, Ballsbridge, Dublin, D04 E6W0. Tel: 660 9000 Fax: 660 9099 E-Mail: info@mea.ie Web: www.mea.ie

CLIENT:
INDAVER

PROJECT:
SITE SUSTAINABILITY PROJECT

TITLE:
PROPOSED WAREHOUSE, WORKSHOP & OFFICE/ERT FIRST FLOOR GA

DESIGNED: NK	CHECKED: JMD	APPROVED: NK
DRAWN: NK	DATE: SEPT 19	SCALE: As indicated

DRG No:	29043-CD-402	REV:	C
---------	---------------------	------	----------